



## Expandable Container House

Multiple design and color options Robust and adaptable structure for all seasons We guide you throughout for a turnkey process



Our expandable container houses are a great alternative for standard homes. These modular sections can be joined together to make a beautiful home at half the cost of typical homes. Perfect for wilderness seekers and city lovers alike..

### Specification and configuration 20 feet

Model	Expandable 20FT
Expandable Size	L 18' 7" x W 21'0" x H 8'
Internal Size	L 37' 8" x W 19'8" x H 7' 3"
Folded Size	L 38' 7" x W 7'4" x H 8'
Floor Area	72m <sup>2</sup> 775 square feet
House Type	4 Bedrooms, 1 bathroom
People Number	4~12 people
Power	12 kw
Net Weight	5.3 ton 11 023.1 LBS

### Specification and configuration 30 feet

Model	Expandable 30FT
Expandable Size	L 28' 7" x W 21'0" x H 8'
Internal Size	L 37' 8" x W 19'8" x H 7' 3"
Folded Size	L 38' 7" x W 7'4" x H 8'
Floor Area	72m <sup>2</sup> 775 square feet
House Type	4 Bedrooms, 1 bathroom
People Number	4~12 people
Power	12 kw
Net Weight	5.3 ton 11 023.1 LBS

### Specification and configuration 40 feet

Model	Expandable 40FT
Expandable Size	L 38' 7" x W 21'0" x H 8'
Internal Size	L 37' 8" x W 19'8" x H 7' 3"
Folded Size	L 38' 7" x W 7'4" x H 8'
Floor Area	72m <sup>2</sup> 775 square feet
House Type	4 Bedrooms, 1 bathroom
People Number	4~12 people
Power	12 kw
Net Weight	5.3 ton 11 023.1 LBS





Frame Structure			
No.	Name	Content	Specification
1	Main Frame (Fully galvanized)	Top Side Beam	80*100*3.75mm 3" x 3".9" x 0.1" Galvanized Square Tube
2		Top Beam	Galvanized bending parts 3.0mm
3		Top longitudinal secondary beam	30*30*1.3mm 0.2" x 0.2" x 0.03" Galvanized Square Tube
4		Top transverse secondary beam	40*60*1.8mm 1.5" x 2.3" x 0.03" Galvanized Square Tube
5		Bottom Side Beam	80*100*3.0mm 3" x 3".9" x 0.11" Galvanized Square Tube
6		Bottom Beam	Galvanized bending parts 3.0mm 0.11"
7		Bottom longitudinal secondary beam	80*100*3.0mm 3" x 3".9" x 0.11" Galvanized Square Tube
8		Bottom transverse secondary beam	40*80*2.0mm 1.5" x 3" x 0.07" Galvanized Square Tube
9		6mm Galvanized hanging head	Galvanized hanging head L210*W150*H160mm 8'.26" x 5.9" x 6'.03"
10		Steel Column	Galvanized bending parts 3.0mm
11	Side Frame (Fully galvanized)	Top Frame	50*100*3.0mm Galvanized Square Tube
12			Galvanized bending parts 3.0mm
13		Bottom Frame	80*100*3.0mm Galvanized Square Tube
14		Folding hinge	130mm Galvanized hinge
15	Overall Framework Protective Coating	Spray	Electrostatic spraying/straight white plastic powder coating process + anti-corrosion coating
16	Roof	External Top Plate	950 type - 100mm thick double-sided 0.3mm, PU color steel composite board + corrugated single board t0.45mm
17		Internal Ceiling panel	950 type - 100mm thick double-sided 0.3mm, PU color steel composite board
18	Wallboard	Side wall, Front and Rear	950 type - 100mm thick double-sided 0.3mm, PU color steel composite board
19		Inner Partition Board	950 type - 100mm thick double-sided 0.3mm, PU color steel composite board
20	Ground	Floor	Fireproof Bamboo plywood 18mm
21		Warm oneself	Electric heating floor
22		Floor exterior finishing	SPC 4.0mm
23		Bottom insulation	40mm XPS + 0.6mm bottom guard plate
24	Door and Window	Broken bridge aluminum sliding window	920*920mm*8 Double-layer coated glass 5+14+5mm thick
25		Broken bridge aluminum double door	840*2035mm Double-layer coated glass 5+14+5mm thick
26		Bedroom door	Aluminum wooden door*4
27	Electrial	Circuit breaker system	American standard circuits, switches, sockets
28		Light	Bull brand 30*30 Flat lamp.Large Ceiling Lamp
29	Bathroom	Dry and wet separation	Titanium-magnesium alloy door, glass sliding door, shower, wash basin, smart light-filling mirror cabinet, toilet, floor drain, hidden water pipe.
30	Spare Parts	Including top corner line, skirting, corner wrap, waterproof tape, sling, structural adhesive , glue gun	
Loading	Container 40HQ*1		



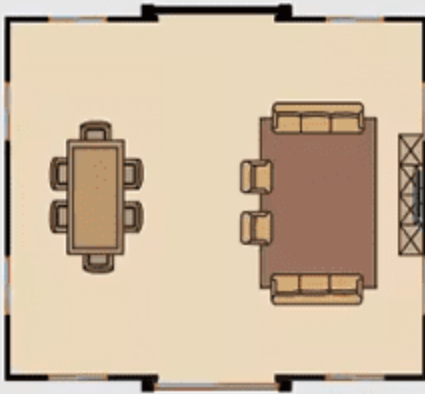

One Living room



One Living room  
One Bedroom  
One Restroom



One Living room  
One Bedroom  
One Restroom



One Living room  
Two Bedrooms  
One Restroom



One Living room  
Two Bedrooms  
One Restroom



One Living room  
Three Bedrooms  
One Restroom

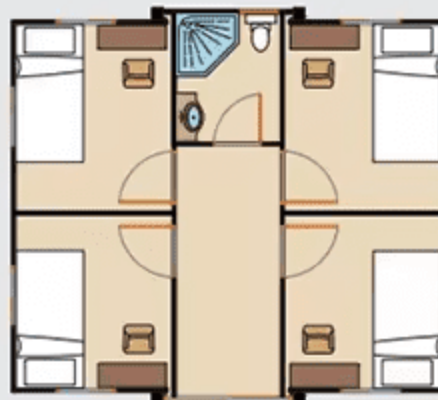

Four Bedrooms  
One Restroom

(Layout examples)





## The new age of container houses



The modern appearance, large windows for breathtaking views, and smart gadgets are ideal for both city dwellers and those who like the outdoors.

Our Expandable models are a great alternative for traditional living. These expandable container houses make beautiful homes at half the cost of typical homes.



Ready for our Canadian winters!



Insulation R ratings\* A 150mm thick polyurethane foam insulation layer will typically have an R-value between R-22.5 and R-42, depending on the specific type of polyurethane foam. Closed-cell spray polyurethane foam typically has an R-value of R-6.5 to R-7 per inch. Therefore, 150mm (approximately 6 inches) of closed-cell spray foam would have an R-value of roughly R-39 to R-42. Rigid foam boards, like polyisocyanurate, can also have higher R-values per inch, with some reaching R-6.5 per inches



# Preparation and transport to Canada



Your new container house will be carefully prepared for its journey across international waters. We're utilizing a state-of-the-art cargo ship, complete with advanced GPS navigation, to ensure a secure transit. Your container house is scheduled to arrive safely at your nearest Canadian port. We will provide regular updates on its progress every step of the way.

Here are some additional details that could be included:

## Shipping Preparation:

- \* The container will undergo a thorough inspection to ensure it meets all safety and shipping regulations.
- \* It will be securely strapped and braced within the cargo ship to prevent movement during transit.

## Transportation:

- \* The cargo ship is equipped with climate control to protect the contents from extreme temperatures.
- \* The route will be optimized for speed and safety, taking into account weather conditions and potential hazards.

## Arrival and Delivery:

- \* Upon arrival, the container house will be unloaded and prepared for customs clearance.
- \* We will coordinate with you to arrange for transportation to your final destination.
- \* We will provide you with all necessary documentation and support throughout the process



**Maisons Conteneurs Canada**  
Container Houses Canada

873 200-0963

[maisonsconteneurscanada.ca](http://maisonsconteneurscanada.ca)

[containerhousescanada.ca](http://containerhousescanada.ca)